

nylex

5L

Hand Sprayer

Instruction Manual

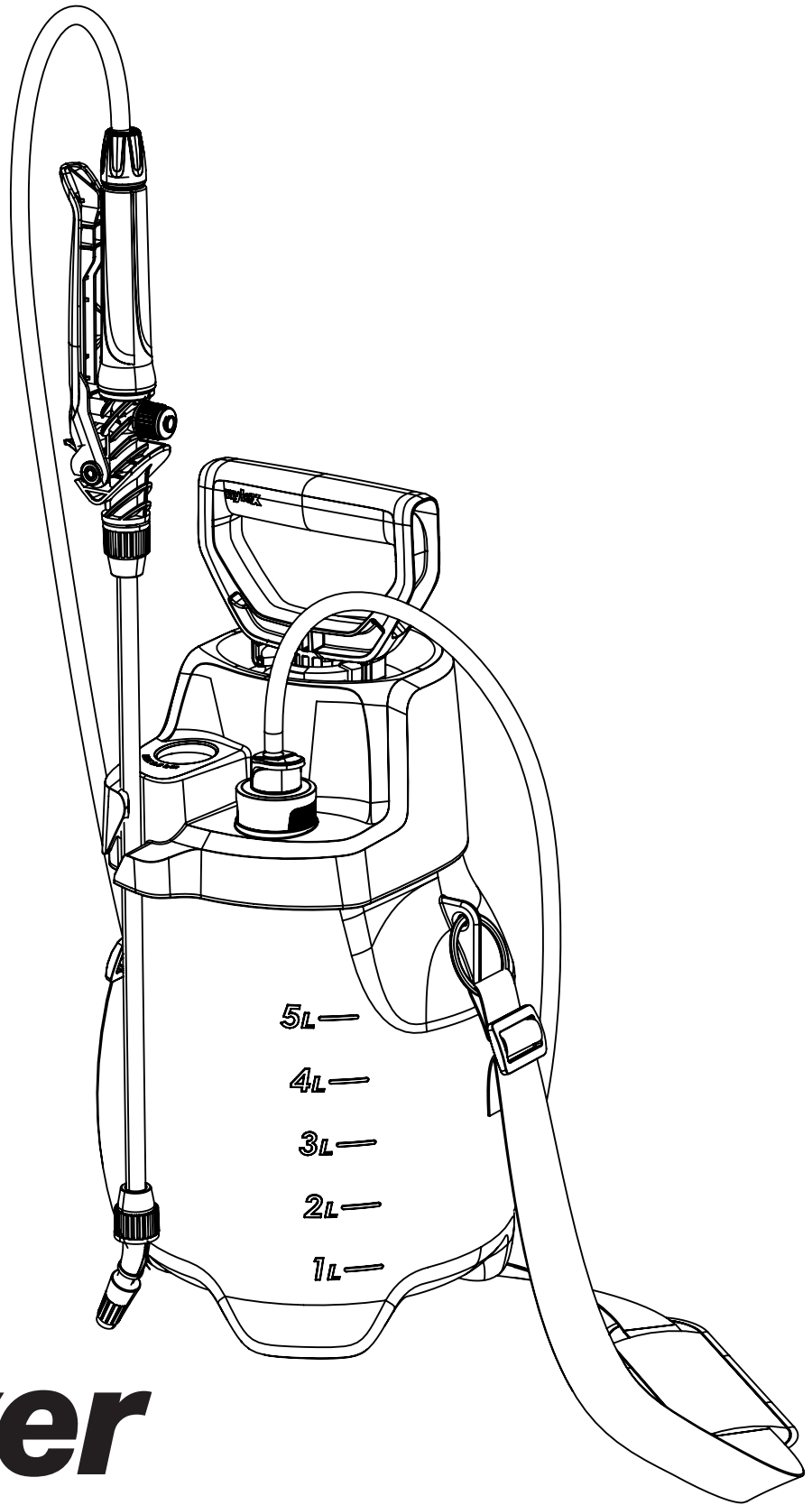

nylex

Hand Sprayer Instruction Manual

Product Code: 50137709

Caution



Read instruction manual completely before operating this sprayer.
Failure to comply may result in serious injury.

- The sprayer is designed and manufactured solely for use with liquid chemicals used for gardening, horticulture, agriculture and disinfecting when resistance to aggressive chemicals is required. Under no circumstances may it be used for any other purposes.
- Refer to the MSDS Sheet or chemical manufacturer for correct use and safe handling instructions of chemicals before filling or using the sprayer.
- Never use this sprayer with any flammable liquids, caustics, acids or hot water.
- Always wear the recommended safety protective clothing and equipment when handling chemicals and operating the sprayer.
- Refer to the chemical manufacturer for correct disposal of empty chemical containers and chemical residue.
- Keep the sprayer and all chemicals out of the reach of pets or children.

Included Parts

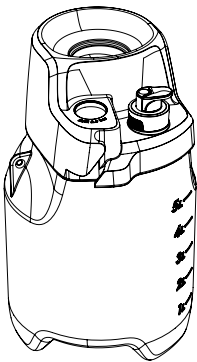

Tank (A)

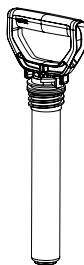

Pump Handle (C)



Lance (F)

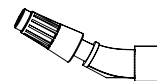

Cone Spray Nozzle (G)

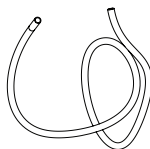

Hose (D)

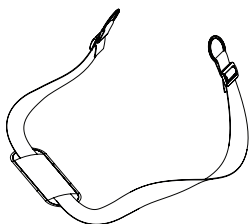

Shoulder Strap (B)

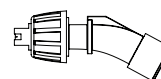

Assembly Instructions

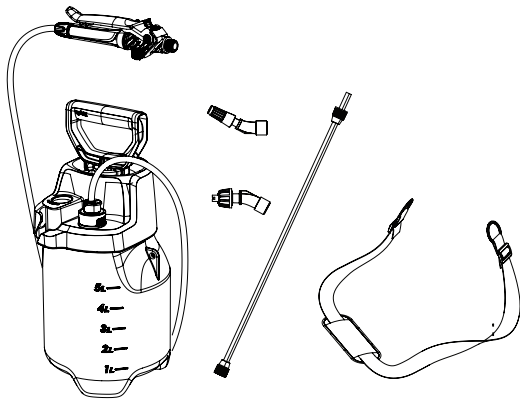

Step 1

Remove the sprayer and components from the carton.

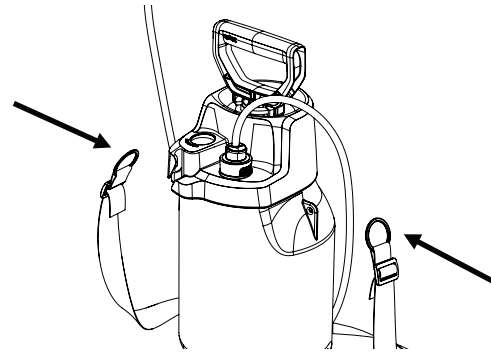

Step 2

Secure the shoulder strap (B) by sliding the metal split rings into the designated strap holes on the side of the tank.

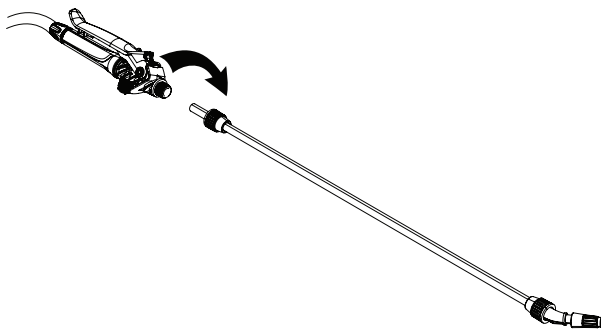

Step 3

Connect the lance (F) to the trigger handle (E) and secure by tightening the nut.

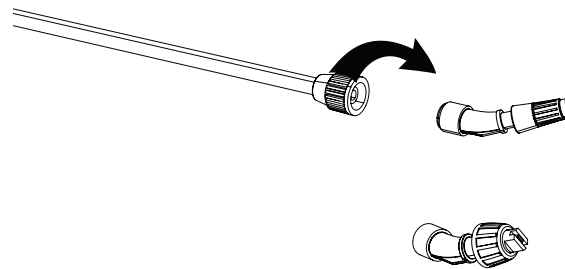

Step 4

Select the cone nozzle (G) or the fan nozzle (H) and then screw the chosen nozzle on the lance (F).

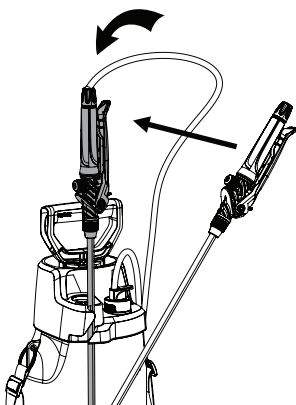

Step 5

Secure the lance (F) to the holder on the bottle by angling and snapping in place.

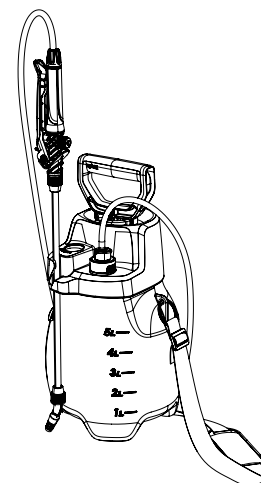

Step 6

The sprayer is now ready for filling.

Operation Instructions



Warning

Read instruction manual completely before operating this sprayer.
Failure to comply may result in serious injury.

- Always check the MSDS Sheet or consult the chemical manufacturer before use.
- Never use this sprayer with any flammable liquids, caustics, acids or hot water.
- Always release sprayer pressure when not in use or performing any maintenance.
- Test the sprayer with water before using with chemical solutions.
- Always inspect all hose connections before each use. Damaged components may cause exposure to pressurised chemicals, resulting in serious injury.
- Avoid exposing the strap to any chemicals and check for any signs of fraying.
- Carry the sprayer by the handle or straps only.

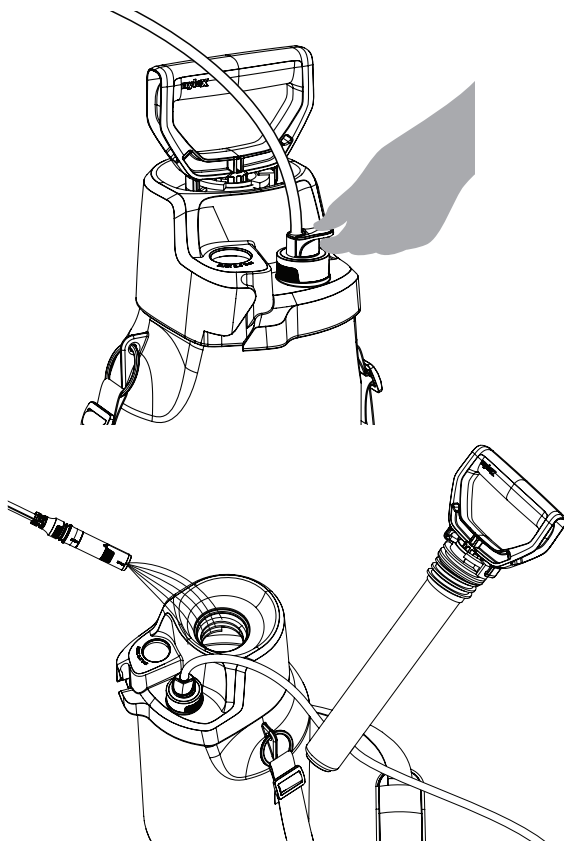

Filling:

1. Stand the sprayer tank (A) on a level surface, release any pressure from sprayer by lifting the safety relief valve and twisting the pump handle (C) anti-clockwise.
2. Before filling the sprayer with a chemical solution, fill the sprayer with water to check all connections points do not leak. Screw the handle (C) back onto sprayer until it is tightly sealed.
3. Check all connection points and pour out the water.
4. Fill the tank (A) with water/chemical solution to the desired level. Do not fill above the maximum capacity. Screw the handle (C) back onto sprayer until it is tightly sealed.

Nylexpert Tip

When using chemicals, do not immerse the end of the hose in the solution when filling from the central water supply. Sudden low pressure may cause the solution to be sucked back into the water supply.

Nozzle Selection

Different spray tips are supplied to provide a variety of spray patterns.

(H) Flat Fan Nozzle

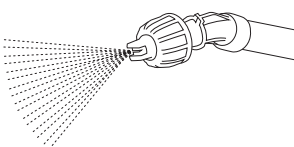

(G) Cone Spray Nozzle

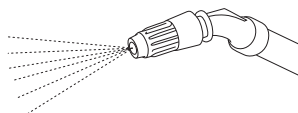

The cone spray nozzle can be adjusted from a scatter spray (A) to a stream spray (B).

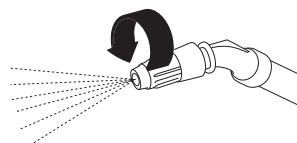

A. For a scatter spray, turn the nozzle clockwise.



B. For a stream spray, turn the nozzle counterclockwise.

Operation Instructions



Warning

Read instruction manual completely before operating this sprayer.
Failure to comply may result in serious injury.

- Carry the sprayer by the handle or straps only.
- Do not spray in windy conditions or near open flames, as this may cause ignition or uncontrolled chemical exposure.
- Always wear the recommended safety protective clothing and equipment when handling chemicals and operating the sprayer.
- Always direct the nozzle away from your face and body during use.

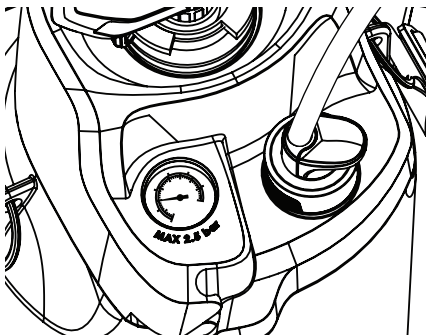
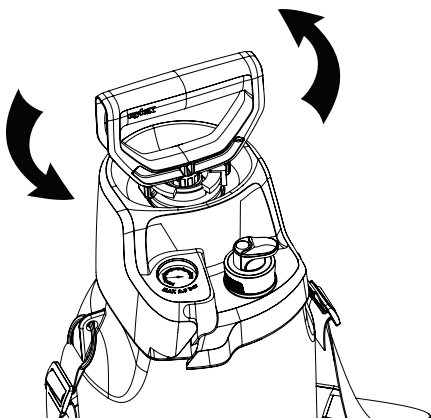

The Sprayer Is Now Ready For Use:

1. Ensure proper posture when lifting the sprayer and adjust shoulder strap (B) as needed.
2. Check that the trigger lock (E) is not engaged to prevent unwanted spray.
3. Unlock the pump handle (C) from the collar by twisting it until the handle is released.
4. Pump the handle to pressurise the sprayer and monitor the pressure via the pressure gauge. **Do not over-pressurise.**
5. Release the spray by using the trigger sprayer. Switch control from intermittent to continuous spray by holding down the handle and flicking down the trigger lock (E).
6. Pump the handle (C) as needed to maintain sprayer pressure.
7. After use, secure the lance (F) onto the lance holder for storage.

Intermittent Spraying:

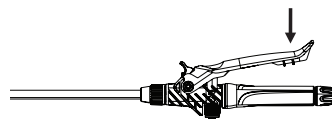

Continuous Spraying:

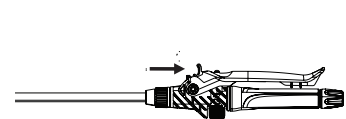

Sprayer Aftercare



Warning

Read instruction manual completely before operating this sprayer.
Failure to comply may result in serious injury.

- Carry the sprayer by the handle or straps only.
- Always release sprayer pressure when not in use or performing any maintenance.
- Never attempt to clear any nozzles or components by mouth. Always direct the nozzle away from your face and body during use.
- Do not leave the sprayer in the sun when not in use.
- Always clean and rinse the sprayer thoroughly after each use. Do not store any chemicals in the sprayer.
- Never attempt to alter the sprayer from its original condition. Maintain it using only original manufacturer parts.

Sprayer Aftercare

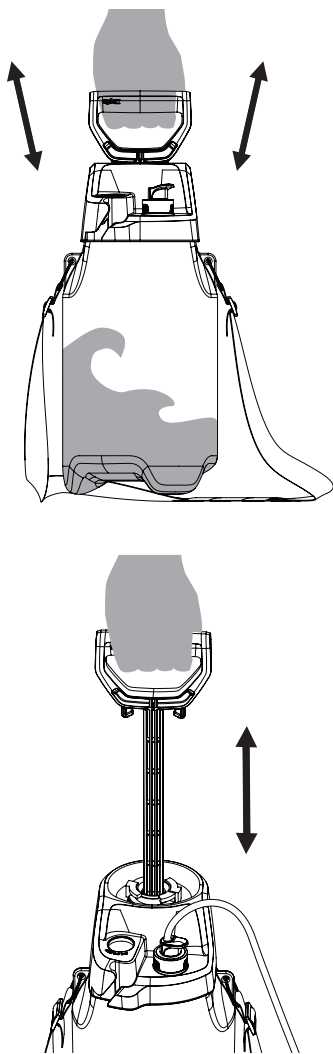

Maintenance & Cleaning:

1. Always release pressure when the sprayer is not in use or before carrying out any maintenance. This is done by lifting safety relief valve and letting out as much air as possible.
2. Once all the pressure has been released, unscrew the pump handle (C) by turning it anti-clockwise and empty any liquid left inside the tank (A).
3. Fill the tank (A) with cool, clean tap water, and replace pump handle (C) back onto sprayer. Shake the sprayer to ensure it rinses all internal surfaces.
4. Use the pump handle (C) and trigger (E) to flush out the sprayer until the tank (A) is empty. Repeat if needed.
5. Remove the nozzle (H/G) and rinse under cold water to remove any chemical build up. Replace back onto sprayer or a safe place.
6. Ensure the sprayer is not pressurised and tank (A) contains no liquid. Allow the sprayer to fully dry and store in a cool dry place, out of direct sunlight and out of reach of children and pets.

Nylex expert Tip

Seals used with harsh chemicals can degrade over time. Inspect seals regularly and replace as needed to maintain performance and safety.

Warranty

AMES Australasia Pty Ltd (AMES) guarantees that this product will be free from defects in workmanship and materials for 3 years from the date of purchase. If such a defect becomes evident during that period, AMES will, at its option, either repair, replace or refund the product. In the event of such a defect, the product should be returned to the place of purchase (together with proof of purchase and the original packaging) at the address below. Any handling and transportation costs (and other expenses incurred in claiming under this guarantee) are not covered by this guarantee and will not be borne by AMES. The obligation of AMES under this guarantee is limited to the circumstances set out above and is subject to; the customer being able to evidence the acquisition of the product, the purchase price paid for the product and the relevant defect in materials or workmanship; the product not having been altered, tampered with or otherwise dealt with by any person in a manner other than as intended in respect of the relevant product; and the product not having been used or applied in a manner that is contrary to customary usage or application for the relevant product or contrary to any stated instructions or specifications of AMES. In addition to other rights and remedies that may be available under law, our goods come with guarantees that cannot be excluded under the Australian Consumer Law (for consumers in Australia) and the Consumer Guarantees Act (for consumers in NZ). If you are a consumer in Australia, you are entitled to a replacement or refund for a major failure and compensation for any other reasonably foreseeable loss or damage. You are also entitled to have the goods repaired or replaced if the goods fail to be of acceptable quality and the failure does not amount to a major failure. If you are a consumer in New Zealand, we will comply with our obligations to you under the Consumer Guarantees Act.

For further information contact us on

Email: nylex@amesau.com
Australia Free Call: 1300 381 559
New Zealand: 0800 447 144

AMES Australasia
ABN 89 169 427 061
Level 1, 660 Doncaster Road,
Doncaster, Victoria, 3108, Australia.



@nylexwatering
www.nylex.com.au

Important: If for some reason your sprayer needs to be returned for warranty purposes, PLEASE wash it out thoroughly to protect our service technicians from exposure to unknown substances.



Scan for more information